

Licensing Sub-Committee

Friday 3 August 2018

10.00 am

Ground Floor Meeting Room G02A - 160 Tooley Street, London SE1 2QH

Membership

Councillor Adele Morris (Vice-Chair, in the Chair)

Councillor Sunny Lambe

Councillor Charlie Smith

Reserves

Councillor Eliza Mann

INFORMATION FOR MEMBERS OF THE PUBLIC

Access to information

You have the right to request to inspect copies of minutes and reports on this agenda as well as the background documents used in the preparation of these reports.

Babysitting/Carers allowances

If you are a resident of the borough and have paid someone to look after your children, an elderly dependant or a dependant with disabilities so that you could attend this meeting, you may claim an allowance from the council. Please collect a claim form at the meeting.

Access

The council is committed to making its meetings accessible. Further details on building access, translation, provision of signers etc for this meeting are on the council's web site: www.southwark.gov.uk or please contact the person below.

Contact

Andrew Weir on 020 7525 7222 or email: Andrew.weir@southwark.gov.uk

Members of the committee are summoned to attend this meeting

Eleanor Kelly

Chief Executive

Date: 24 July 2018



Licensing Sub-Committee

Friday 3 August 2018
10.00 am

Ground Floor Meeting Room G02A - 160 Tooley Street, London SE1 2QH

Order of Business

Item No.	Title	Page No.
-----------------	--------------	-----------------

PART A - OPEN BUSINESS

1. APOLOGIES

To receive any apologies for absence.

2. CONFIRMATION OF VOTING MEMBERS

A representative of each political group will confirm the voting members of the committee.

3. NOTIFICATION OF ANY ITEMS OF BUSINESS WHICH THE CHAIR DEEMS URGENT

In special circumstances, an item of business may be added to an agenda within five clear days of the meeting.

4. DISCLOSURE OF INTERESTS AND DISPENSATIONS

Members to declare any interests and dispensation in respect of any item of business to be considered at this meeting.

5. LICENSING ACT 2003: RINNEROON,130 DRUID STREET, LONDON SE1 2HH	1 - 66
--	---------------

ANY OTHER OPEN BUSINESS AS NOTIFIED AT THE START OF THE MEETING AND ACCEPTED BY THE CHAIR AS URGENT.

PART B - CLOSED BUSINESS**EXCLUSION OF PRESS AND PUBLIC**

The following motion should be moved, seconded and approved if the sub-committee wishes to exclude the press and public to deal with reports revealing exempt information:

“That the public be excluded from the meeting for the following items of business on the grounds that they involve the likely disclosure of exempt information as defined in paragraphs 1-7, Access to Information Procedure rules of the Constitution.”

ANY OTHER CLOSED BUSINESS AS NOTIFIED AT THE START OF THE MEETING AND ACCEPTED BY THE CHAIR AS URGENT.

Date: 24 July 2018

Item No. 5.	Classification: Open	Date: 3 August 2018	Meeting Name: Licensing Sub-Committee
Report Title		Licensing Act 2003: Rinneroon,130 Druid Street, London SE1 2HH	
Ward(s) of group(s) affected		London Bridge and West Bermondsey	
From		Strategic Director of Environment and Social Regeneration	

RECOMMENDATION

1. That the licensing sub-committee considers an application made by Rinneroon Ltd for a premises licence to be granted under the Licensing Act 2003 in respect of the premises known as Rinneroon, 130 Druid Street, London SE1 2HH.
2. Notes:
 - a) This application forms a new application for a premises licence, submitted under Section 17 of the Licensing Act 2003. The application is subject to representations from responsible authorities and other persons and is therefore referred to the sub-committee for determination.
 - b) Paragraphs 8 to 11 of this report provide a summary of the application under consideration by the sub-committee. A copy of the full application is attached as Appendix A.
 - c) Paragraphs 12 to 20 of this report deal with the representations submitted and any further correspondence in respect of the application. Copies of the representations are attached as Appendices B, C , D and E.
 - d) Paragraph 24 deals with licensed premises within a 100 metre radius of the premises. A map of the area is attached as Appendix F.
 - e) A copy of the council's approved procedure for hearings of the sub-committee in relation to an application made under the Licensing Act 2003, along with a copy of the hearing regulations, has been circulated to all parties to the meeting.

BACKGROUND INFORMATION

The Licensing Act 2003

3. The Licensing Act 2003 provides a licensing regime for:
 - The sale of and supply of alcohol
 - The provision of regulated entertainment
 - The provision of late night refreshment.
4. Within Southwark, the licensing responsibility is wholly administered by this council.

5. The Act requires the licensing authority to carry out its functions under the Act with a view to promoting the four stated licensing objectives. These are:
 - The prevention of crime and disorder
 - The promotion of public safety
 - The prevention of nuisance
 - The protection of children from harm.
6. In carrying out its licensing functions, a licensing authority must also have regard to
 - The Act itself
 - The guidance to the act issued under Section 182 of the Act
 - Secondary regulations issued under the Act
 - The licensing authority's own statement of licensing policy
 - The application, including the operating schedule submitted as part of the application
 - Relevant representations.
7. The premises licence application process involves the provision of all relevant information required under the Act to the licensing authority with copies provided by the applicant to the relevant responsible bodies under the Act. The application must also be advertised at the premises and in the local press. The responsible authorities and other persons within the local community may make representations on any part of the application where relevant to the four licensing objectives.

KEY ISSUES FOR CONSIDERATION

The premises licence application

8. On 7 June 2018, Rinneroon Ltd applied to this council for the grant of a premises licence in respect of Rinneroon, 130 Druid Street, London SE1 2HH. The premises is described as Network Rail archway with a small area outside the premises on the road. The premises is currently empty, however it will be transformed into a home for a community led running club. It will store merchandise, have an office space and have a section where running relate foods and beverages can be sold.
9. The application is summarised as follows:
 - **Supply of alcohol (on the premises)**
 - Monday to Sunday from 12:00 to 23:00.
 - **Operating hours**
 - Monday to Saturday from 12:00 to 23:00
 - Sunday from 11:00 to 23:00.
10. The premises licence application form provides the applicant's operating schedule. Parts J, K, L, and M of the operating schedule set out the proposed licensable activities, operating hours and operating control measures in full, with reference to the four licensing objectives as stated in the Licensing Act 2003. Should a premises licence be issued in respect of the application the information provided in the operating schedule will form the basis of conditions that will be attached to any

licence granted subsequent to the application. A copy of the application is attached to this report as Appendix A.

Designated premises supervisor

11. The proposed designated premises supervisor (DPS) Tim Jones has a personal licence issued by the Southwark Council.

Representations from responsible authorities

12. There are representations from the Metropolitan Police Service, environmental protection team (EPT), licensing (as a responsible authority) and health and safety.
13. The police representation states that the premises are located in a railway arch in a mainly residential street and there are large residential blocks opposite. The premises does not benefit from an outside area on Druid Street and opens directly onto the pavement/loading bay which is a public highway with no border to the road. The area where the premises is located is becoming saturated with licensed premises and the use of outside areas is having a cumulative impact on the area causing public nuisance to local residents including public urination and obstructions to passing traffic putting people in danger. They have proposed a number of conditions to the applicant for consideration.
14. The EPT were concerned that the controls listed in the application were insufficient to ensure the prevention of public nuisance licensing objective. Specifically they had concerns about noise and nuisance from people externally and dispersal from the premises affecting residents directly opposite. Further to that, they were concerned that there was no usable external area to the premises as this opens directly onto a loading bay which forms part of the carriageway. A number of conditions were proposed to the applicant for consideration. The EPT and the applicant have now conciliated and the EPT have since withdrawn their representation.
15. The licensing representation states that due to the limited information on the application form and in order to promote the licensing objectives, they have asked the applicant to provide additional information. Furthermore the application has not left any time between the last sale of alcohol 'on sales' and the closing time when patrons should have left the premises and have requested that the application be amended so that the 'on sales' of alcohol shall cease at least half an hour before the closing time of the premises. They have also proposed a number of conditions for consideration.
16. Health and safety have asked the applicant to explain how he will deal with public safety. They are concerned that customers who want to sit outside drinking will be sitting on the public highway where cars drive by and there is a risk of vehicles driving into customers drinking outside in the proposed area. They also requested for a risk assessment to be submitted. The necessary information has since been submitted and the representation has now been withdrawn.
17. The representations are attached as Appendix B.

Representations from other persons

18. There are 16 representations from other persons. Four of the representations are opposed to the application and 12 of the representations are in support of the application.

19. The people opposed to the application state that the area is already saturated by outlets providing alcoholic beverages. The behaviour of the patrons to the above outlets is noisy and anti-social and consists of (loud chanting and singing, people right outside homes and gardens using the estate to sit and consume their alcohol, urinating on the estate (all in front of children), sitting on the pavements with legs in the road causing passing motorists to have to sound their hooters to get past).
20. Those in support of the applicant believe that the club increases the social bond in the community by bringing together people from all walks of life. The club, being a running club, encourages the health and well being of its members as well as networking amongst members before and after running events.
21. The representations are attached as Appendix C.

Conciliation

22. The representations were forwarded to the applicant's representative. The applicant has responded with a conciliation statement which has been circulated to all parties concerned. The EPT and health and safety have withdrawn their representations after conciliating with the applicant. The conciliation statements and the subsequent withdrawal emails are attached as Appendices D and E. The licensing sub-committee will be updated on 3 August 2018 of any developments.

Deregulation of entertainment

23. On 6 April 2015 entertainment became deregulated and as a result:
 - Live unamplified music is deregulated between 08:00 and 23:00 on any premises.
 - Live and recorded amplified music is deregulated between 08:00 and 23:00 at on-licensed premises provided the audience does not exceed 500 people, however, live music can become licensable in on-licensed premises if the licensing authority removes the effect of the deregulation following a licence review ('licence review mechanism').

Map of the local area

24. A map of the area is attached to this report as Appendix F. For purposes of scale only the circle on the map has a 100 metre radius. The following licensed premises terminal hours are also shown on the map.

Public houses/restaurant/brewery

- Marquis of Wellington PH, 21 Druid Street, London SE1 (Monday to Wednesday until 23.00 Thursday until 00.00, Friday and Saturday until 01.00 and Sun until 00.00) - Currently closed.
- Elmadero, Railway Arch 840, 30 Druid Street, London SE1 (Monday to Sunday until 23.00)
- Southwark Brewing Company Limited, 46 Druid Street, London SE1 (Monday to Sunday until 23.00)

- Doodle Bar, 60 Druid Street, SE1 (Sunday to Thursday until 00:00, Friday and Saturday until 01:00)
 - St John Bakery Company Ltd, 72 Druid Street, London SE1 (Monday to Sunday until 23:00)
 - Bea's of Bloomsbury Railway Arch, 76 Druid Street, London SE1 (Monday to Sunday until 22:00)
 - Speckmobile Railway Arch, 76 Druid Street, London SE1 (Monday to Saturday until 23:00 and Sunday until 22:30)
 - Hawkes, 92 Druid Street, London SE1 (Monday to Sunday until 23:00)
 - Comptoir Gourmand, 98 Druid Street, London SE1 (Monday to Sunday until 23:00)
 - Anspach & Hobday, 116 - 118 Druid Street, London SE1 (Monday to Sunday until 23:00)
 - Bottles, 128 Druid Street, London SE1 (Monday to Sunday until 23:00)
 - Lemporio, 134 Druid Street, London SE1 (Sunday to Wednesday until 22:00 and Thursday to Saturday until 23:00)
 - Thames Takeaway, 140 Tanner Street, London SE1 (Sunday to Thursday until 00:00 and Sunday until 00:30)
 - Ronnies Supermarket, 116-118 Tanners Street, London SE1 (Monday to Saturday until 23:00 and Sunday until 22:30)
 - Lassco, Ropewalk and Arches 46 and 48 to 53, London SE1 (Wednesday to Saturday until 22:00 and Sunday until 17:00)
 - Lassco, 37 Maltby Street, London SE1 (Monday to Sunday until 23:00)
 - Maltby Restaurant, 40 Maltby Street, London SE1 (Monday and Tuesday until 23:30, Wednesday and Sat till 01:00; Sun till 17:30).
25. Within the Southwark statement of licensing policy 2016 - 2020 the following closing times are recommended as appropriate within this area for this categories of premises as follows:
- Closing time for restaurant, cafés, public houses wine bars or other drinking establishments:
 - 23:00 daily.

Southwark council statement of licensing policy

26. Council assembly approved Southwark's statement of licensing policy 2016 - 2020 on 25 November 2015. The policy came into effect on 1 January 2016. Sections of the

statement that are considered to be of particular relevance to the sub-committee's consideration are:

- Section 3 - Purpose and scope of the policy. This reinforces the four licensing objectives and the fundamental principles upon which this authority relies in determining licence applications.
 - Section 5 - Determining applications for premises licences and club premises certificates. This explains how the policy works and considers issues such as location; high standards of management; and the principles behind condition setting.
 - Section 6 - Local cumulative impact policies. This sets out this authority's approach to cumulative impact and defines the boundaries of the current special policy areas and the classifications of premises to which they apply. To be read in conjunction with Appendix B to the policy.
 - Section 7 - Hours of operation. This provides a guide to the hours of licensed operation that this authority might consider appropriate by type of premises and (planning) area classification.
 - Section 8 - The prevention of crime and disorder. This provides general guidance on the promotion of the first licensing objective.
 - Section 9 - Public safety. This provides general guidance on the promotion of the second licensing objective.
 - Section 10 - The prevention of nuisance. This provides general guidance on the promotion of the third licensing objective.
 - Section 11 - The protection of children from harm. This provides general guidance on the promotion of the fourth licensing objective
27. The purpose of Southwark's statement of licensing policy is to make clear to applicants what considerations will be taken into account when determining applications and should act as a guide to the sub-committee when considering the applications. However, the sub-committee must always consider each application on its own merits and allow exceptions to the normal policy where these are justified by the circumstances of the application.

Resource implications

28. A fee of £190.00 has been paid by the applicant company in respect of this application being the statutory fee payable for premises within non-domestic rateable value band B.

Consultation

29. Consultation has been carried out on this application in accordance with the provisions of the Licensing Act 2003. A public notice was published in a local newspaper and similar notices were exhibited outside of the premises for a period of 28 consecutive days.

Community impact statement

30. Each application is required by law to be considered upon its own individual merits with all relevant matters taken into account.

SUPPLEMENTARY ADVICE FROM OTHER OFFICERS

Director of Law and Democracy

31. The sub-committee is asked to determine the application for a premises licence under section 17 of the Licensing Act 2003.
32. The principles which sub-committee members must apply are set out below.

Principles for making the determination

33. The general principle is that applications for premises licence applications must be granted unless relevant representations are received. This is subject to the proviso that the applicant has complied with regulations in advertising and submitting the application.
34. Relevant representations are those which:
- Are about the likely effect of the granting of the application on the promotion of the licensing objectives
 - Are made by an interested party or responsible authority
 - Have not been withdrawn
 - Are not, in the opinion of the relevant licensing authority, frivolous or vexatious.
35. If relevant representations are received then the sub-committee must have regard to them, in determining whether it is necessary for the promotion of the licensing objectives to:
- To grant the licence subject to:
 - The conditions mentioned in section 18 (2)(a) modified to such extent as the licensing authority considers necessary for the promotion of the licensing objectives
 - Any condition which must under section 19, 20 or 21 be included in the licence.
 - To exclude from the scope of the licence any of the licensable activities to which the application relates.
 - To refuse to specify a person in the licence as the premises supervisor.
 - To reject the application.

Conditions

36. The sub-committee's discretion is thus limited. It can only modify the conditions put forward by the applicant, or refuse the application, if it is necessary to do so. Conditions must be necessary and proportionate for the promotion of one of the four licensing objectives, and not for any other reason. Conditions must also be within the

control of the licensee, and should be worded in a way which is clear, certain, consistent and enforceable.

37. The four licensing objectives are:

- The prevention of crime and disorder
- Public safety
- The prevention of nuisance
- The protection of children from harm.

38. Members should note that each objective is of equal importance. There are no other licensing objectives, and the four objectives are paramount considerations at all times.

39. Conditions will not be necessary if they duplicate a statutory position. Conditions relating to night café and take away aspect of the license must relate to the night time operation of the premises and must not be used to impose conditions which could not be imposed on day time operators.

40. Members are also referred to the Home Office Revised Guidance issued under section 182 of the Licensing Act 2003 on conditions, specifically section 10.

Reasons

41. If the sub-committee determines that it is necessary to modify the conditions, or to refuse the application for a premises licence application, it must give reasons for its decision.

Hearing procedures

42. Subject to the licensing hearing regulations, the licensing committee may determine its own procedures. Key elements of the regulations are that:

- The hearing shall take the form of a discussion led by the authority. Cross examination shall not be permitted unless the authority considered that it is required for it to consider the representations.
- Members of the authority are free to ask any question of any party or other person appearing at the hearing.
- The committee must allow the parties an equal maximum period of time in which to exercise their rights to:
 - Address the authority
 - If given permission by the committee, question any other party.
 - In response to a point which the authority has given notice it will require clarification, give further information in support of their application.
- The committee shall disregard any information given by a party which is not relevant to the particular application before the committee and the licensing objectives.
- The hearing shall be in public, although the committee may exclude the public from all or part of a hearing where it considers that the public interest in doing

so outweighs the public interest in the hearing, or that part of the hearing, taking place in private.

- In considering any representations or notice made by a party the authority may take into account documentary or other information produced by a party in support of their application, representations or notice (as applicable) either before the hearing or, with the consent of all the other parties, at the hearing.
43. This matter relates to the determination of an application for a premises licence under section 17 of the Licensing Act 2003. Regulation 26(1) (a) requires the sub-committee to make its determination at the conclusion of the hearing.

Council's multiple roles and the role of the licensing sub-committee

44. Sub-committee members will note that, in relation to this application, the council has multiple roles. Council officers from various departments have been asked to consider the application from the perspective of the council as authority responsible respectively for environmental health, trading standards, health and safety and as the planning authority.
45. Members should note that the licensing sub-committee is meeting on this occasion solely to perform the role of licensing authority. The sub-committee sits in quasi-judicial capacity, and must act impartially. It must offer a fair and unbiased hearing of the application. In this case, members should disregard the council's broader policy objectives and role as statutory authority in other contexts. Members must direct themselves to making a determination solely based upon the licensing law, guidance and the council's statement of licensing policy.
46. As a quasi-judicial body the licensing sub-committee is required to consider the application on its merits. The sub-committee must take into account only relevant factors, and ignore irrelevant factors. The decision must be based on evidence, that is to say material, which tends logically to show the existence or non-existence of relevant facts, or the likelihood or unlikelihood of the occurrence of some future event, the occurrence of which would be relevant. The licensing sub-committee must give fair consideration to the contentions of all persons entitled to make representations to them.
47. The licensing sub-committee is entitled to consider events outside of the premises if they are relevant, i.e. are properly attributable to the premises being open. The proprietors do not have to be personally responsible for the incidents for the same to be relevant. However, if such events are not properly attributable to the premises being open, then the evidence is not relevant and should be excluded. Guidance is that the licensing authority will primarily focus on the direct impact of the activities taking place at the licensed premises on members of the public, living, working or engaged in normal activity in the area concerned.
48. Members will be aware of the council's code of conduct which requires them to declare personal and prejudicial interests. The code applies to members when considering licensing applications. In addition, as a quasi-judicial body, members are required to avoid both actual bias, and the appearance of bias.
49. The sub-committee can only consider matters within the application that have been raised through representations from other persons and responsible authorities. Other persons must live in the vicinity of the premises. This will be decided on a case to case basis.

50. Under the Human Rights Act 1998, the sub-committee needs to consider the balance between the rights of the applicant and those making representations to the application when making their decision. The sub-committee has a duty under section 17 Crime and Disorder Act 1998 when making its decision to do all it can to prevent crime and disorder in the borough.
51. Other persons, responsible authorities and the applicant have the right to appeal the decision of the sub-committee to the magistrates' court within a period of 21 days beginning with the day on which the applicant was notified by the licensing authority of the decision to be appealed against.

Guidance

52. Members are required to have regard to the Home Office Revised Guidance in carrying out the functions of licensing authority. However, guidance does not cover every possible situation, so long as the guidance has been properly and carefully understood, members may depart from it if they have reason to do so. Full reasons must be given if this is the case.

Strategic Director of Finance and Governance

53. The head of community safety and enforcement has confirmed that the costs of this process are borne by the service.

BACKGROUND DOCUMENTS

Background Papers	Held At	Contact
Licensing Act 2003 Home Office revised Guidance to the Act Secondary Regulations Southwark statement of licensing Policy Case file	Southwark Licensing, C/O Community Safety & Enforcement, 160 Tooley Street, London, SE1 2QH	Kirty Read Tel: 020 7525 5748

APPENDICES

Name	Title
Appendix A	Application for a premises licence
Appendix B	Representations submitted by responsible authorities
Appendix C	Representations submitted by other persons
Appendix D	Conciliation email
Appendix E	Withdrawal emails
Appendix F	Map of area

AUDIT TRAIL

Lead Officer	Deborah Collins, Strategic Director of Environment and Social Regeneration		
Report Author	Dorcas Mills, Principal Licensing Officer		
Version	Final		
Dated	20 July 2018		
Key Decision?	No		
CONSULTATION WITH OTHER OFFICERS / DIRECTORATES / CABINET MEMBER			
Officer Title	Comments sought	Comments included	
Director of Law and Democracy	Yes	Yes	
Strategic Director of Finance and Governance	Yes	Yes	
Cabinet Member	No	No	
Date final report sent to Constitutional Team		23 July 2018	

APPENDIX A

**Application for a premises licence to be granted
under the Licensing Act 2003**

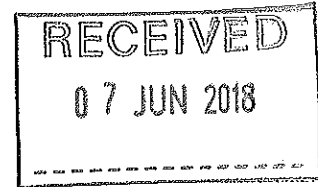

PLEASE READ THE FOLLOWING INSTRUCTIONS FIRST

Before completing this form please read the guidance notes at the end of the form. If you are completing this form by hand please write legibly in block capitals. In all cases ensure that your answers are inside the boxes and written in black ink. Use additional sheets if necessary.

You may wish to keep a copy of the completed form for your records.

I/We Rinneroon Ltd

(Insert name(s) of applicant)

apply for a premises licence under section 17 of the Licensing Act 2003 for the premises described in Part 1 below (the premises) and I/we are making this application to you as the relevant licensing authority in accordance with section 12 of the Licensing Act 2003

Part 1 – Premises details

Postal address of premises or, if none, ordnance survey map reference or description			
130 Druid Street			
Post town	London	Postcode	SE1 2HH

Telephone number at premises (if any)	
Non-domestic rateable value of premises	£ 18,250

Part 2 - Applicant details

Please state whether you are applying for a premises licence as Please tick as appropriate

- | | | |
|--|-------------------------------------|-----------------------------|
| a) an individual or individuals * | <input type="checkbox"/> | please complete section (A) |
| b) a person other than an individual * | | |
| i as a limited company/limited liability partnership | <input checked="" type="checkbox"/> | please complete section (B) |
| ii as a partnership (other than limited liability) | <input type="checkbox"/> | please complete section (B) |
| iii as an unincorporated association or | <input type="checkbox"/> | please complete section (B) |
| iv other (for example a statutory corporation) | <input type="checkbox"/> | please complete section (B) |
| c) a recognised club | <input type="checkbox"/> | please complete section (B) |
| d) a charity | <input type="checkbox"/> | please complete section (B) |

- e) the proprietor of an educational establishment ☐ please complete section (B)
- f) a health service body ☐ please complete section (B)
- g) a person who is registered under Part 2 of the Care Standards Act 2000 (c14) in respect of an independent hospital in Wales ☐ please complete section (B)
- ga) a person who is registered under Chapter 2 of Part 1 of the Health and Social Care Act 2008 (within the meaning of that Part) in an independent hospital in England ☐ please complete section (B)
- h) the chief officer of police of a police force in England and Wales ☐ please complete section (B)

* If you are applying as a person described in (a) or (b) please confirm (by ticking yes to one box below):

- I am carrying on or proposing to carry on a business which involves the use of the premises for licensable activities; or ☐
- I am making the application pursuant to a statutory function or ☐
- a function discharged by virtue of Her Majesty's prerogative ☐

(A) INDIVIDUAL APPLICANTS (fill in as applicable)

Mr <input type="checkbox"/>	Mrs <input type="checkbox"/>	Miss <input type="checkbox"/>	Ms <input type="checkbox"/>	Other Title (for example, Rev)	
Surname			First names		
Date of birth		I am 18 years old or over <input type="checkbox"/>		Please tick yes	
Nationality					
Current residential address if different from premises address					
Post town				Postcode	
Daytime contact telephone number					
E-mail address (optional)					

SECOND INDIVIDUAL APPLICANT (if applicable)

Mr <input type="checkbox"/>	Mrs <input type="checkbox"/>	Miss <input type="checkbox"/>	Ms <input type="checkbox"/>	Other Title (for example, Rev)	
Surname			First names		

Date of birth		I am 18 years old or over <input type="checkbox"/> Please tick yes	
Nationality			
Current postal address if different from premises address			
Post town		Postcode	
Daytime contact telephone number			
E-mail address (optional)			

(B) OTHER APPLICANTS

Please provide name and registered address of applicant in full. Where appropriate please give any registered number. In the case of a partnership or other joint venture (other than a body corporate), please give the name and address of each party concerned.

Name Rinneroon Ltd
Address 130 Druid Street London SE1 2HH
Registered number (where applicable) 11400196
Description of applicant (for example, partnership, company, unincorporated association etc.) We are a ltd company that run London's largest free running club and community.
Telephone number (if any)
E-mail address (optional)

Part 3 Operating Schedule

When do you want the premises licence to start? 8.6.2018

If you wish the licence to be valid only for a limited period, when do you want it to end?

DD		MM		YYYY			
1	1	1	1	1	1	1	1

Please give a general description of the premises (please read guidance note 1)

This is a Network Rail archway on Druid Street not far from Tower Bridge. It currently is completely empty other than one disused toilet. There is a small area outside the premises on the road that other businesses nearby have cordoned off for outside space.

The archway will be turned into a home for our community led running club that has been going for 9 years. We've won various awards for volunteering. We'll store merchandise, have an office space, and have a section where running related foods and beverages can be sold.

If 5,000 or more people are expected to attend the premises at any one time, please state the number expected to attend.

N/A

What licensable activities do you intend to carry on from the premises?

(please see sections 1 and 14 and Schedules 1 and 2 to the Licensing Act 2003)

Provision of regulated entertainment (please read guidance note 2)

Please tick all that apply

- a) plays (if ticking yes, fill in box A) ☐
- b) films (if ticking yes, fill in box B) ☐
- c) indoor sporting events (if ticking yes, fill in box C) ☐
- d) boxing or wrestling entertainment (if ticking yes, fill in box D) ☐
- e) live music (if ticking yes, fill in box E) ☐
- f) recorded music (if ticking yes, fill in box F) ☐
- g) performances of dance (if ticking yes, fill in box G) ☐
- h) anything of a similar description to that falling within (e), (f) or (g) (if ticking yes, fill in box H) ☐

Provision of late night refreshment (if ticking yes, fill in box I)

☐

Supply of alcohol (if ticking yes, fill in box J)

x

In all cases complete boxes K, L and M

A

Plays Standard days and timings (please read guidance note 7)			<u>Will the performance of a play take place indoors or outdoors or both – please tick</u> (please read guidance note 3)	Indoors	<input type="checkbox"/>
				Outdoors	<input type="checkbox"/>
				Both	<input type="checkbox"/>
Day	Start	Finish			
Mon			<u>Please give further details here</u> (please read guidance note 4)		
Tue					
Wed			<u>State any seasonal variations for performing plays</u> (please read guidance note 5)		
Thur					
Fri			<u>Non standard timings. Where you intend to use the premises for the performance of plays at different times to those listed in the column on the left, please list</u> (please read guidance note 6)		
Sat					
Sun					

B

Films Standard days and timings (please read guidance note 7)			<u>Will the exhibition of films take place indoors or outdoors or both – please tick</u> (please read guidance note 3)	Indoors	<input type="checkbox"/>
				Outdoors	<input type="checkbox"/>
				Both	<input type="checkbox"/>
Day	Start	Finish			
Mon			<u>Please give further details here</u> (please read guidance note 4)		
Tue					
Wed.			<u>State any seasonal variations for the exhibition of films</u> (please read guidance note 5)		
Thur					
Fri			<u>Non standard timings. Where you intend to use the premises for the exhibition of films at different times to those listed in the column on the left, please list</u> (please read guidance note 6)		
Sat					
Sun					

C

Indoor sporting events Standard days and timings (please read guidance note 7)			<u>Please give further details</u> (please read guidance note 4)
Day	Start	Finish	
Mon			
Tue			<u>State any seasonal variations for indoor sporting events</u> (please read guidance note 5)
Wed			
Thur			
Fri			<u>Non standard timings. Where you intend to use the premises for indoor sporting events at different times to those listed in the column on the left, please list</u> (please read guidance note 6)
Sat			
Sun			

D

Boxing or wrestling entertainments Standard days and timings (please read guidance note 7)			<u>Will the boxing or wrestling entertainment take place indoors or outdoors or both – please tick</u> (please read guidance note 3)	Indoors	<input type="checkbox"/>
				Outdoors	<input type="checkbox"/>
				Both	<input type="checkbox"/>
Day	Start	Finish	<u>Please give further details here</u> (please read guidance note 4)		
Mon					
Tue					
Wed			<u>State any seasonal variations for boxing or wrestling entertainment</u> (please read guidance note 5)		
Thur					
Fri					
Sat			<u>Non standard timings. Where you intend to use the premises for boxing or wrestling entertainment at different times to those listed in the column on the left, please list</u> (please read guidance note 6)		
Sun					

E

Live music Standard days and timings (please read guidance note 7)			<u>Will the performance of live music take place indoors or outdoors or both – please tick</u> (please read guidance note 3)	Indoors	<input type="checkbox"/>
				Outdoors	<input type="checkbox"/>
				Both	<input type="checkbox"/>
Day	Start	Finish	<u>Please give further details here</u> (please read guidance note 4)		
Mon					
Tue					
Wed			<u>State any seasonal variations for the performance of live music</u> (please read guidance note 5)		
Thur					
Fri					
Sat			<u>Non standard timings. Where you intend to use the premises for the performance of live music at different times to those listed in the column on the left, please list</u> (please read guidance note 6)		
Sun					

F

Recorded music Standard days and timings (please read guidance note 7)			<u>Will the playing of recorded music take place indoors or outdoors or both – please tick</u> (please read guidance note 3)	Indoors	<input type="checkbox"/>
				Outdoors	<input type="checkbox"/>
				Both	<input type="checkbox"/>
Day	Start	Finish	<u>Please give further details here</u> (please read guidance note 4)		
Mon					
Tue					
Wed			<u>State any seasonal variations for the playing of recorded music</u> (please read guidance note 5)		
Thur					
Fri					
Sat			<u>Non standard timings. Where you intend to use the premises for the playing of recorded music at different times to those listed in the column on the left, please list</u> (please read guidance note 6)		
Sun					

G

Performances of dance Standard days and timings (please read guidance note 7)			<u>Will the performance of dance take place indoors or outdoors or both – please tick</u> (please read guidance note 3)	Indoors	<input type="checkbox"/>
				Outdoors	<input type="checkbox"/>
				Both	<input type="checkbox"/>
Day	Start	Finish	<u>Please give further details here</u> (please read guidance note 4)		
Mon					
Tue					
Wed			<u>State any seasonal variations for the performance of dance</u> (please read guidance note 5)		
Thur					
Fri					
Sat			<u>Non standard timings. Where you intend to use the premises for the performance of dance at different times to those listed in the column on the left, please list</u> (please read guidance note 6)		
Sun					

H

Anything of a similar description to that falling within (e), (f) or (g) Standard days and timings (please read guidance note 7)			Please give a description of the type of entertainment you will be providing		
Day	Start	Finish	<u>Will this entertainment take place indoors or outdoors or both – please tick</u> (please read guidance note 3)	Indoors	<input type="checkbox"/>
Mon				Outdoors	<input type="checkbox"/>
				Both	<input type="checkbox"/>
Tue			<u>Please give further details here</u> (please read guidance note 4)		
Wed					
Thur			<u>State any seasonal variations for entertainment of a similar description to that falling within (e), (f) or (g)</u> (please read guidance note 5)		
Fri					
Sat			<u>Non standard timings. Where you intend to use the premises for the entertainment of a similar description to that falling within (e), (f) or (g) at different times to those listed in the column on the left, please list</u> (please read guidance note 6)		
Sun					



I

Late night refreshment Standard days and timings (please read guidance note 7)			Will the provision of late night refreshment take place indoors or outdoors or both – please tick (please read guidance note 3)	Indoors	<input type="checkbox"/>
				Outdoors	<input type="checkbox"/>
				Both	<input type="checkbox"/>
Day	Start	Finish	<u>Please give further details here</u> (please read guidance note 4)		
Mon					
Tue					
Wed			<u>State any seasonal variations for the provision of late night refreshment</u> (please read guidance note 5)		
Thur					
Fri					
Sat			<u>Non standard timings. Where you intend to use the premises for the provision of late night refreshment at different times, to those listed in the column on the left, please list</u> (please read guidance note 6)		
Sun					

J

Supply of alcohol Standard days and timings (please read guidance note 7)			Will the supply of alcohol be for consumption – please tick (please read guidance note 8)	On the premises	<input checked="" type="checkbox"/>
				Off the premises	<input type="checkbox"/>
				Both	
Day	Start	Finish	State any seasonal variations for the supply of alcohol (please read guidance note 5)		
Mon	12:00	23:00			
Tue	12:00	23:00			
Wed	12:00	23:00			
Thur	12:00	23:00			
Fri	12:00	23:00			
			Non standard timings. Where you intend to use the premises for the supply of alcohol at different times to those listed in the column on the left, please list (please read guidance note 6)		
Sat	12:00	23:00			
Sun	12:00	23:00			

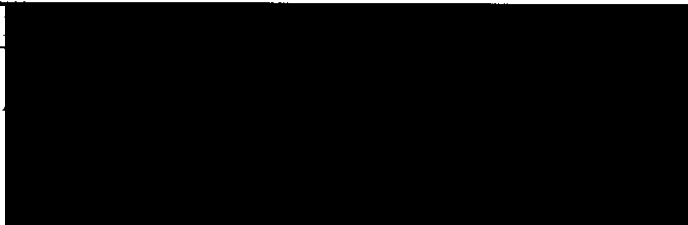
State the name and details of the individual whom you wish to specify on the licence as designated premises supervisor (Please see declaration about the entitlement to work in the checklist at the end of the form):

Name	
Tim Jones	
	
Postcode	
Personal licence number (if known)	
	
Issuing licensing authority (if known)	
BIIAB APLH Level 2 Award for Personal Licence Holders	



K

Please highlight any adult entertainment or services, activities, other entertainment or matters ancillary to the use of the premises that may give rise to concern in respect of children (please read guidance note 9).

N/A

L

Hours premises are open to the public Standard days and timings (please read guidance note 7).			State any seasonal variations (please read guidance note 5)
Day	Start	Finish	
Mon	12:00	23:00	Non standard timings. Where you intend the premises to be open to the public at different times from those listed in the column on the left, please list (please read guidance note 6)
Tue	12:00	23:00	
Wed	12:00	23:00	
Thur	12:00	23:00	
Fri	12:00	23:00	
Sat	12:00	23:00	
Sun	11:00	23:00	

M Describe the steps you intend to take to promote the four licensing objectives:

a) General – all four licensing objectives (b, c, d and e) (please read guidance note 10)

The venue's purpose is to house our running club which has been going for over 8 years. The emphasis therefore is promoting free exercise and giving advice and help to our thriving running community. We've won 3 awards for volunteering and are supported by MP Neil Coyle as we were by his predecessor Simon Hughes. We've also featured recently on BBC breakfast promoting our Couch to 5k programme, as well as on ITV news and the local press. All of this makes us quite unlike any of the breweries and establishments nearby which we feel will help us provide something new in the area promoting health and wellbeing.

We have been meeting in other venues along Druid Street for many years, and therefore are not going to be increasing the volume of people visiting the area once our venue opens. For over a year we have been meeting within 100 feet of the new venue in a nearby pub without any complaint from nearby residents.

As a long established club, we already have terms and conditions to ensure that the safety and welfare of the public is protected. We revoke membership of the club to anyone who behaves non-respectfully to other members, the venue staff, or members of the public. Over the years this has happened very rarely and we have a community of long-established members, many of whom are well-respected professionals and members of the local community. A number of our members live in the housing estate directly opposite the venue.

The venue will also serve and be visited by members of the public outside of our main club session times, but they would be in the minority and are expected to observe our rules in relation to the license objectives.

Very few of our runners smoke so there should not be a need for large numbers to continually congregate outside. In warmer weather some runners may stand in the outside space on Druid Street next to the road, but we will make sure this number is always low and we'll ensure that it is cordoned off and that the number of people never exceeds 30. SIA staff will be employed if necessary to make sure that the number doesn't go over x25 in order to give us a buffer.

Often we will have running related workshops within the arch, but these will be ticketed to limit numbers and will not be heard from the outside of the venue. We give water to our members on running nights and these will be served in recyclable cups with our logo. All bottles and refuse will be disposed of very quietly and before 10pm at night.

All staff will be trained to enforce Challenge 25 and to use the incident log in case of any incidents.

Any music will just be ambient music kept at low volume. Tuesday is our busiest night of the week and usually almost all runners have left the venue by 9.30pm

b) The prevention of crime and disorder

CCTV will be put on the premises both at the counter and the entrance to the property. The staff will be trained to look out for any suspicious activity and if crimes are suspected this will be reported to the police.

c) Public safety

If at any point a member of staff sees a customer who appears to be intoxicated they will immediately inform the duty manager. Service will be refused should they try to buy another drink. The duty manager will ask them politely to leave explaining that it's not personal but it's for professional reasons. They will also be offered water. If they become unruly they will be asked to leave the premises and on all occasions this will be recorded in the service log.

Glassware will be regularly collected from inside and outside the area and any broken glass swept up and disposed of immediately. We will also conduct regular head counts inside and outside the property every half an hour. We'll have all the relevant fire and safety notices in place.

d) The prevention of public nuisance

Any patrons inside who are causing nuisance by shouting, chanting or causing trouble which could cause annoyance to nearby residents will be asked to keep the noise down. If they ignore this then they will be reported to the duty manager and they will be asked to leave. The incident will be recorded in an incident log. We'll add posters on drinking and driving in the toilets and drink aware posters.

e) The protection of children from harm

Membership of our running club is only open to adults over the age of 18. Children do occasionally visit the club but always accompanied by a parent/guardian and under no circumstances would ever be served alcohol.

We will use challenge 25 to prevent anyone under the age of 18 buying or consuming alcohol. Staff will be trained to recognise the internationally recognised IDs and will check the photos and dates.

Checklist:

Please tick to indicate agreement

- I have made or enclosed payment of the fee. x
- I have enclosed the plan of the premises. x
- I have sent copies of this application and the plan to responsible authorities and others where applicable. x
- I have enclosed the consent form completed by the individual I wish to be designated premises supervisor, if applicable. x
- I understand that I must now advertise my application. x
- I understand that if I do not comply with the above requirements my application will be rejected. x
- x
- [Applicable to all individual applicants, including those in a partnership which is not a limited liability partnership, but not companies or limited liability partnerships] I have included documents demonstrating my entitlement to work in the United Kingdom (please read note 15). x

IT IS AN OFFENCE, UNDER SECTION 158 OF THE LICENSING ACT 2003, TO MAKE A FALSE STATEMENT IN OR IN CONNECTION WITH THIS APPLICATION. THOSE WHO MAKE A FALSE STATEMENT MAY BE LIABLE ON SUMMARY CONVICTION TO A FINE OF ANY AMOUNT.

IT IS AN OFFENCE UNDER SECTION 24B OF THE IMMIGRATION ACT 1971 FOR A PERSON TO WORK WHEN THEY KNOW, OR HAVE REASONABLE CAUSE TO BELIEVE, THAT THEY ARE DISQUALIFIED FROM DOING SO BY REASON OF THEIR IMMIGRATION STATUS. THOSE WHO EMPLOY AN ADULT WITHOUT LEAVE OR WHO IS SUBJECT TO CONDITIONS AS TO EMPLOYMENT WILL BE LIABLE TO A CIVIL PENALTY UNDER SECTION 15 OF THE IMMIGRATION, ASYLUM AND NATIONALITY ACT 2006 AND PURSUANT TO SECTION 21 OF THE SAME ACT, WILL BE COMMITTING AN OFFENCE WHERE THEY DO SO IN THE KNOWLEDGE, OR WITH REASONABLE CAUSE TO BELIEVE, THAT THE EMPLOYEE IS DISQUALIFIED.

Part 4 – Signatures (please read guidance note 11)

Signature of applicant or applicant's solicitor or other duly authorised agent (see guidance note 12). **If signing on behalf of the applicant, please state in what capacity.**

Declaration	<ul style="list-style-type: none"> • [Applicable to individual applicants only, including those in a partnership which is not a limited liability partnership] I understand I am not entitled to be issued with a licence if I do not have the entitlement to live and work in the UK (or if I am subject to a condition preventing me from doing work relating to the carrying on of a licensable activity) and that my licence will become invalid if I cease to be entitled to live and work in the UK (please read guidance note 15). • The DPS named in this application form is entitled to work in the UK (and is not subject to conditions preventing him or her from doing work relating to a licensable activity) and I have seen a copy of his or her proof of entitlement to work, if appropriate (please see note 15)
Signature	
Date	
Capacity	

For joint applications, signature of 2nd applicant or 2nd applicant's solicitor or other authorised agent (please read guidance note 13). If signing on behalf of the applicant, please state in what capacity.

Signature	
Date	
Capacity	

Contact name (where not previously given) and postal address for correspondence associated with this application (please read guidance note 14)			
Post town		Postcode	
Telephone number (if any)			
If you would prefer us to correspond with you by e-mail, your e-mail address (optional)			

Notes for Guidance

1. Describe the premises, for example the type of premises, its general situation and layout and any other information which could be relevant to the licensing objectives. Where your application includes off-supplies of alcohol and you intend to provide a place for consumption of these off-supplies, you must include a description of where the place will be and its proximity to the premises.
2. In terms of specific regulated entertainments please note that:
 - Plays: no licence is required for performances between 08:00 and 23.00 on any day, provided that the audience does not exceed 500.
 - Films: no licence is required for 'not-for-profit' film exhibition held in community premises between 08.00 and 23.00 on any day provided that the audience does not exceed 500 and the organiser (a) gets consent to the screening from a person who is responsible for the premises; and (b) ensures that each such screening abides by age classification ratings.
 - Indoor sporting events: no licence is required for performances between 08.00 and 23.00 on any day, provided that the audience does not exceed 1000.
 - Boxing or Wrestling Entertainment: no licence is required for a contest, exhibition or display of Greco-Roman wrestling, or freestyle wrestling between 08.00 and 23.00 on any day, provided that the audience does not exceed 1000. Combined fighting sports – defined as a contest, exhibition or display which combines boxing or wrestling with one or more martial arts – are licensable as a boxing or wrestling entertainment rather than an indoor sporting event.
 - Live music: no licence permission is required for:
 - a performance of unamplified live music between 08.00 and 23.00 on any day, on any premises.
 - a performance of amplified live music between 08.00 and 23.00 on any day on premises authorised to sell alcohol for consumption on those premises, provided that the audience does not exceed 500.

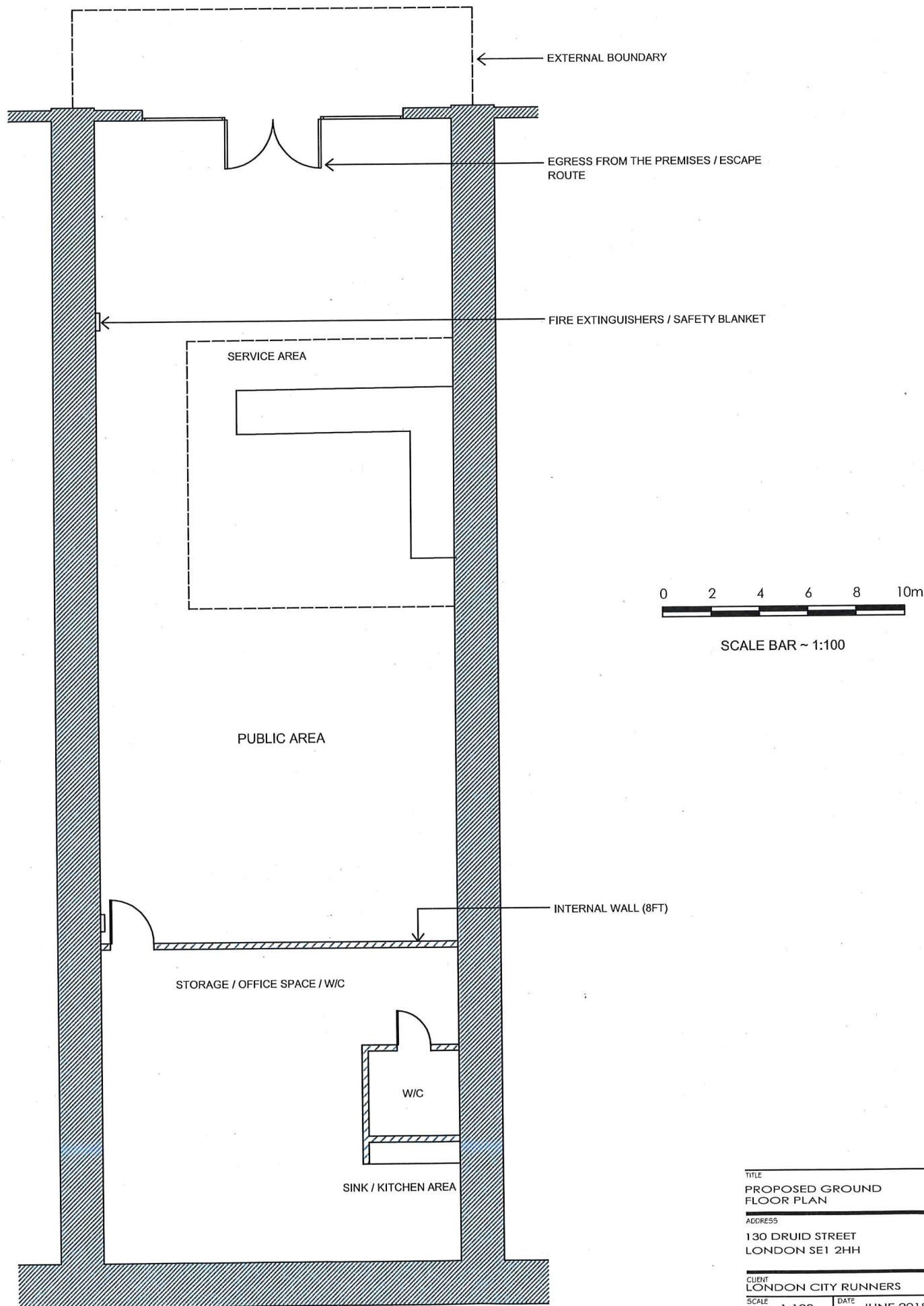

TITLE		
PROPOSED GROUND FLOOR PLAN		
ADDRESS		
130 DRUID STREET LONDON SE1 2HH		
CLIENT		
LONDON CITY RUNNERS		
SCALE	DATE	
1:100	JUNE 2018	
DRAWING No.	REV.	
0001-01		

PUBLIC HIGHWAY

PARKING AND LOADING AREA

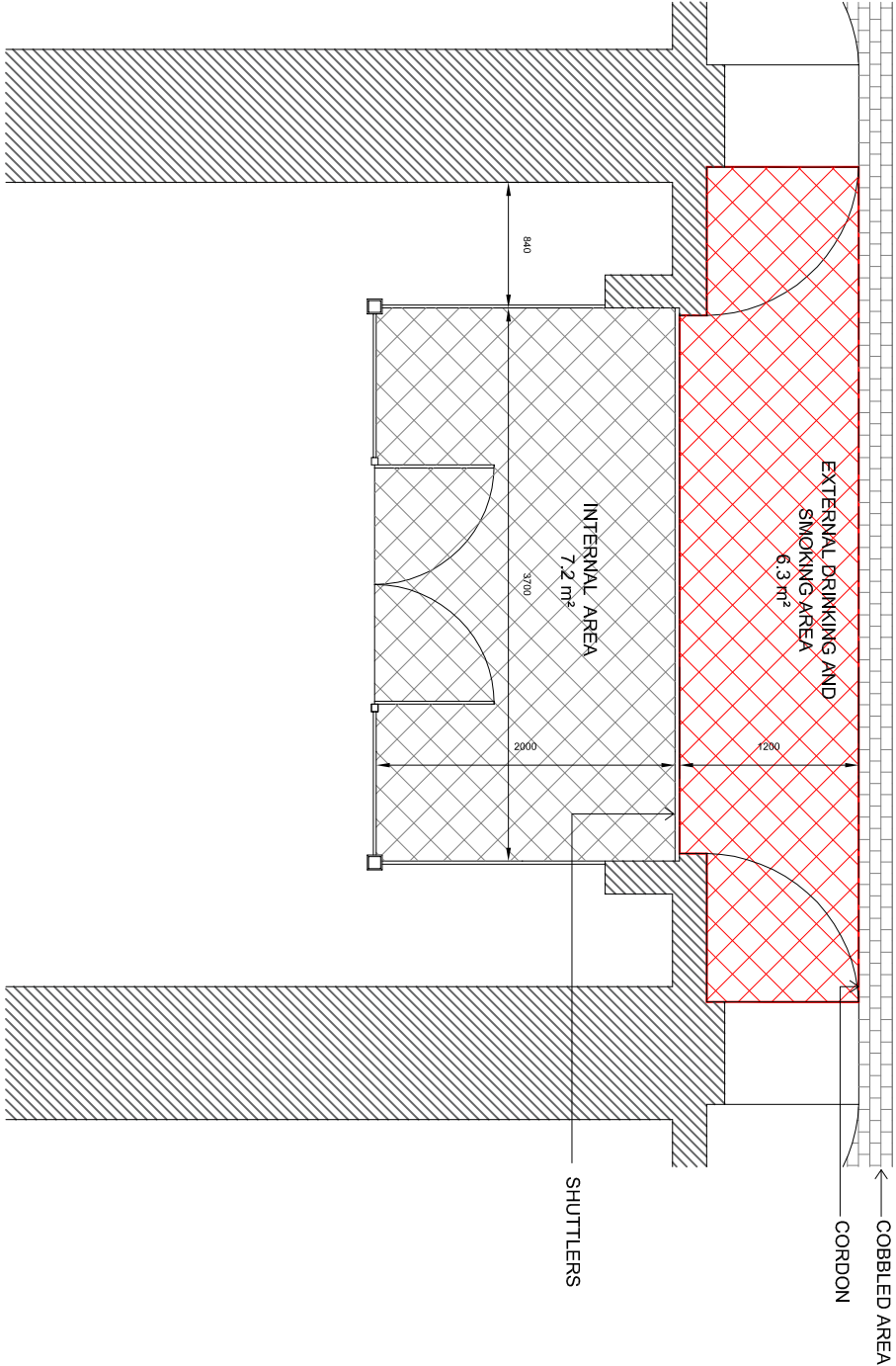

TITLE		
PROPOSED ENTRANCE		
FLOOR PLAN		
ADDRESS		
130 DRUID STREET		
LONDON SE1 2HH		
CLIENT		
LONDON CITY RUNNERS		
SCALE	DATE	
1:50	JULY 2018	
DRAWING No.	REV.	
0002-02		



The Licensing Unit
Floor 3
160 Tooley Street
London
SE1 2QH

Metropolitan Police Service
Licensing Office
Southwark Police Station,
323 Borough High Street,
LONDON,
SE1 1JL

Tel: 020 7232 6756

Email: SouthwarkLicensing@met.police.uk

Our reference: MD/21/3163/18

Date: 2nd July 2018

Dear Sir/Madam

Re:- Rinneroon, 130 Druid Street, London SE1 2HH

Police are in receipt of an application from the above for a new premises licence.

The premises are located in a railway arch in a mainly residential street and there are large residential blocks opposite. The premises does not benefit from an outside area on Druid Street and opens directly onto the pavement/loading bay which is a public highway with no border to the road. The area the premises is located is becoming saturated with licensed premises and the use of outside areas is having a cumulative impact on the area causing public nuisance to local residents including public urination and obstructions to passing traffic putting people in danger.

I have attached two images taken from street view indicating the outside area and the close proximity to residential premises.

Any use of outside area as shown on plans will only cause further public nuisance to the resident opposite and possibly obstruct the highway and possibly be hazardous to traffic and customers due to passing traffic.

The application described the operation as follows:- A community running club to be used to store merchandise, running related food and beverages with an office.

The area has a considerable amount of brewery, food and alcohol lead type venues with groups of people moving between the different licensed premises having consumed alcohol leading to a high possibility of intoxication within the area.

We object to the granting of the licence unless the outside area is removed from the plans and further conditions are placed on the licence to negate complaints about anti-social behaviour, noise nuisance and crime and disorder. The applicant has offered a number of control measure within the application which we welcome and would like to see the wording we have suggested to avoid ambiguity.

1. That a CCTV system be installed at the premises and be maintained in good working order and be continually recording at all times the premises are in use under the licence. The CCTV System must be capable of capturing a clear facial image of every person who enters the premises and all areas the public have access including outside areas.
2. All CCTV footage be kept for a period of 31 days and shall on request be made immediately available to officers of the police and the council.
3. A member of staff should be on duty at all times the premises is open that is trained in the use of the CCTV and able to view and download images to a removable device on request of Police or council officer.
4. That all staff are trained in their responsibilities under the licensing act 2003 and training records to be kept and updated every 6 months and shall, upon request, be made immediately available to Officers of the Police and the Council.
5. No customers should be allowed to take drinks from the licensed area other than to take away and they must be in a sealed container.
6. Customers shall use no outside area other than those who temporarily leave the premises to smoke a cigarette and No more than 5 people at one any time.
7. After 22.30hrs only off sales may be made and must be sold in sealed containers and opened away from the premises.

We would welcome the opportunity to conciliate with the applicant. If they wish to contact me on the above email.

Kind Regards

PC Graham White 288MD
Licensing Officer
Southwark Police Licensing Unit
0207 232 6756



From: Earis, Richard
Sent: Tuesday, July 03, 2018 11:39 AM
To: Regen, Licensing
Subject: Objection to new License application- Rinneroon Ltd 130 Druid Street

RE: New License application- Rinneroon Ltd 130 Druid Street - licence reference number 863537

Please could you pass these comments on to the applicant? No email address has been provided.

I have considered the above application and I would like to object on the grounds that the controls listed in the application are insufficient to ensure the prevention of public nuisance licensing objective. Specifically I am concerned about noise and nuisance from people externally and dispersal from the premises affecting residents directly opposite. Further, there is no usable external area to the premises as this opens directly onto a loading bay which forms part of the carriageway.

I would be happy to withdraw my objections if the applicant can agree to the following conditions:

FIRST OF ALL THANK YOU FOR CONSIDERING ALL MATTERS. I HOPE MY RESPONSES BELOW WILL PROVIDE YOU WITH SUFFICIENT COMFORT. OUR ENTIRE MODEL IS BASED ON ADDING VALUE TO THE COMMUNITY SO WE WILL BE TAKING ALL MATTERS SERIOUSLY TO ENSURE WE DO NOT CAUSE ANY NEGATIVE IMPACT. STAFF WILL ACTIVELY ENSURE THAT CUSTOMERS ACT IN ACCORDANCE WITH OUR STRONG COMMUNITY VALUES, AND HAVE A MINIMAL IMPACT ON OUR NEIGHBOURING BUSINESSES AND RESIDENTS.

- That customers shall not use any outside area to the front of the premises other than those who temporarily leave the premises to smoke, and no more than 5 people shall be permitted to do so at any one time. No drinks shall leave the premises other than off sales that are sold in a sealed container for consumption away from the premises.

WE AGREE WITH THIS BUT WE WOULD REQUEST THAT THE RESTRICTION ON THE MAXIMUM NUMBER OF PEOPLE OUTSIDE BE RESTRICTED TO 20 AT ANY ONE TIME AND WE'LL CORDON OFF THE AREA. WE WILL DO EVERYTHING NECESSARY TO ENSURE THAT PEOPLE FOLLOW ALL RULES AND REGULATIONS AND DO NOT CAUSE ANY NEGATIVE IMPACT OR NOISE NUISANCE TO THE NEIGHBOURS. WE FEEL THIS IS A REASONABLE LIMIT TO HAVE IN OUR OPERATING SCHEDULE, BASED ON THE SIZE OF OUR VENUE AND ANTICIPATED PATRONAGE.

- That alcohol for consumption off the premises is not sold for immediate consumption in the area around the premises and is supplied in sealed containers that require a tool such as a bottle opener or corkscrew to be opened.

AGREED

- External waste handling, collections, deliveries and the cleaning of external areas shall only occur between the hours of 08.00 and 20.00.

AGREED

- Clearly legible signage shall be prominently displayed at all exits where it can easily be seen and read, requesting that customers leave the premises in a quiet and orderly manner that is respectful to neighbours.

AGREED

- Noise from plant, patrons and activities at the premises shall be managed to ensure that public nuisance shall not be caused in the vicinity of the premises or intrude inside the nearest or most exposed noise sensitive premises.

AGREED

- All external doors and doors to noise lobbies used by patrons to enter the premises shall have self-closers to the doors in accordance with BS 6459 Pt. 1 1984.

AGREED

Kind Regards,

Richard

Richard Earis

Principal Environmental Protection Officer

Environmental Protection Team

020 7525 2469

Postal address: Southwark Council | Environmental Protection Team | Regulatory Services | 3rd Floor Hub 1 | PO Box 64529 | London | SE1P 5LX.

Office address (By appointment only): Southwark Council | Environmental Protection Team | Regulatory Services | 3rd Floor Hub 1 | 160 Tooley Street | London | SE1 2QH

www.southwark.gov.uk

visit: <http://www.southwark.gov.uk/air-quality>

<image001.jpg>

Please consider the environment - do you really need to print this email?

From: Tim Jones [<mailto:>]
Sent: Wednesday, July 18, 2018 2:00 PM
To: Earis, Richard
Cc: Mills, Dorcas
Subject: Re: Premises Licence Application - Rinneroon, 130 Druid Street, London S~E1

Dear Richard,

Please find attached a more detailed plan which illustrates the extent of the licensable area. This will not encompass any part of the loading bay. The planning consent is in process and we agree to all of the conditions you've detailed below. All staff will be trained to enforce these conditions.

Kind regards

Tim

On 16 Jul 2018, at 10:10, Earis, Richard <Richard.Earis@southwark.gov.uk> wrote:

Dear Tim,

Thank you for your email.

We have a solution in principle but please could you clarify – is the 'cordon' marked on the plan the extent of your demise? i.e. please confirm this area does not encompass any of the loading bay.

I would suggest you need to resubmit the plan to clarify exactly which area will be used for external drinking (i.e. hatch or shade in red on plan) and with a red boundary line marking the total extent of the licensable area. You need to amend a proper plan as attached rather than the sketch it is too inaccurate to be clear and enforceable for everyone involved.

Please could you also confirm whether you have Planning Consent for change of use of the arch (and the proposed physical works to the facade) and/or if you do not, whether you are in the process of applying for this?

Subject to the above I will be happy to withdraw my objections on the basis that the external area is fully within the licensable area of the premises and does not intrude onto the loading bay, also subject to the following final list of conditions:

- That customers shall not use any area outside the licensable area of the premises, other than those who temporarily leave the premises to smoke, and no more than 5 people shall be permitted to do so at any one time.

Agreed and staff will be trained on this

- No drinks shall leave the licensable area of the premises other than off sales. Alcohol for consumption off the premises shall not be sold for immediate consumption in the area around the

premises and shall be supplied in sealed containers that require a tool such as a bottle opener or corkscrew to be opened.

Agreed

- That no more than 20 patrons shall use the external licensed area of the premises (marked on the submitted plan) at any time and that the external area shall be closed to patrons and fully empty by 21.30 on any day.

Agreed

- Premises management shall regularly monitor the external area to the premises and take all necessary steps to ensure that noise from patrons does not cause disturbance or public nuisance

Agreed this will be part of the training for all staff

- External waste handling, collections, deliveries and the cleaning of external areas shall only occur between the hours of 08.00 and 20.00.

Agreed, this will be part of the training for all staff

- Clearly legible signage shall be prominently displayed at all exits where it can easily be seen and read, requesting that customers leave the premises in a quiet and orderly manner that is respectful to neighbours.

Agreed, we have these signs ready to put up.

- Noise from plant, patrons and activities at the premises shall be managed to ensure that public nuisance shall not be caused in the vicinity of the premises or intrude inside the nearest or most exposed noise sensitive premises.

Agreed

- All external doors and doors to noise lobbies used by patrons to enter the premises shall have self-closers to the doors in accordance with BS 6459 Pt. 1 1984.

Agreed, this has been arranged with our builder

MEMO: Licensing Unit

To	Licensing Unit	Date	5 July 2018	
Copies				
From	Jayne Tear	Telephone	020 7525 0396	Fax
Email	jayne.tear@southwark.gov.uk			

Subject Re: Rinneroon, 130 Druid Street, London, SE1 2HH

– Application for a premises licence

I write with regards to the above application for a premises licence submitted Rinneroon Limited under the Licensing Act 2003, which seeks the following licensable activities:

- Supply of alcohol (on the premises) on Monday to Sunday from 12:00 to 23:00
- Overall opening times shall be on Monday to Sunday from 12:00 to 23:00

The premises is described as

‘This is a Network Rail archway on Druid Street not far from Tower Bridge. It currently is completely empty other than one disused toilet. There is a small area outside the premises on the road that other businesses nearby have cordoned off for outside space. The archway will be turned into a home for our community led running club that has been going for 9 years. We’ve won various awards for volunteering. We’ll store merchandise, have office space and have a section where running related foods and beverages can be sold’

This premises is in a residential area and my representation is submitted under the prevention of crime and disorder and the prevention of public nuisance licensing objectives and has regard to the Southwark Statement of Licensing Policy.

Due to the limited information on the application form and to promote the licensing objectives I ask the applicant to provide the following information:

- An accommodation limit for the premises. (to be conditioned)
- To provide a written dispersal policy for the premises. (to be conditioned)

Furthermore the application has not left any time between the last sale of alcohol ‘on sales’ and the closing time when patrons should have left the premises, this can lead to conflict between staff and the customer having purchased an alcoholic drink for consumption on the premises minutes before closing time and being asked to either finish the drink or hand it back and to leave the premises. Additionally this will encourage patrons to rush consumption of alcoholic drinks at the same time of closing which can lead to antisocial behaviour problems when patron have left the premises.

Therefore I also ask the applicant to consider:

- Amending the licensable activities so that the ‘on sales’ of alcohol shall cease at least half hour before the closing time of the premises.(22:30)

To further promote the licensing objectives add the following conditions to the operating schedule as follows:

- That no drinks in opened containers shall be allowed outside the premises, which includes the area directly outside the front exit door
- The management shall provide information on the premises of local taxi companies

I therefore submit this representation and welcome any discussion with the applicant to consider the above representation

Southwark's Statement of Licensing Policy 2016 – 2020 can be found on the following link:

<http://lbs-mapweb-01:9080/connect/Includes/APPIMA/SSOLP1620.pdf>

Jayne Tear
Principal Licensing officer
In the capacity of the Licensing Responsible Authority

MEMO: Licensing Unit

To Licensing Department Date 27th June 2018

Copies

From Farhad Chowdhury Telephone 020 7525 0398 Fax

Email Farhad.chowdhury@southwark.gov.uk

Subject: **Rinneroon, 130 Druid Street London SE1 2HH**

I write in reference to the application submitted by Rinneroon, for a new premises Licence and I would make the following comments.

I have read the application and I would like some clarifications on the following;

- 1) **Explain how the applicant will deal with public safety, customers who want to sit outside drinking will be sitting on the public highway where cars drive by, there is a risk of vehicles driving into customers drinking outside in the proposed area. There is a serious risk of road accidents/collisions with on Druid street due to the number of vehicles using the road day and night. It is not a suitable to allow drinking outside on the public highway unless suitable measures are put in place.**
- 2) **A comprehensive site specific risk assessments to be done by a competent person and submitted to this Department.**

I therefore **Object** to this variation application on grounds of **Public Safety** until the matters above have been addressed properly.

Farhad Chowdhury
Principal Enforcement Officer

1

[REDACTED]
Message:

I wish to oppose license for 130 Druid st London se1 2dx. This will be fourth drinking outlet within feet of each other, children will watch the display of drunks using our home as toilet, to have sex, the noise levels from present drinking outlet is horrific and prevents sleep, peace quite. Rubbish on estate and in Druid st

[REDACTED]
[REDACTED]
[REDACTED]
[REDACTED]

2

From: [REDACTED]
Sent: Saturday, June 16, 2018 6:47 PM
To: Regen, Licensing;
Subject: Opposing license

[REDACTED]
[REDACTED]
[REDACTED]

To Whom it may concern

Re: License application for 130 Druid Street

It has come to my attention that a company by the name of Rinneroon Ltd is applying for a license for the supply of alcohol, provision of entertainment and provision of late night refreshment.

I strongly oppose this license being granted for the following reasons:

- The area is already saturated by outlets providing alcoholic beverages.
- Anspach and Hobday, The Bottle Shop and Marquis of Wellington plus more outlets further down Druid Street.
- The behaviour of the patrons to the above outlets is noisy and antisocial.
- Loud chanting and singing
- People right outside our homes and gardens using the estate to sit and consume their alcohol.
- Urinating on the estate (all in front of children)
- Sitting on the pavements with legs in the road causing passing motorists to have to sound their hooters to get past. (more noise)
- Drunken patrons gathering in the street (from pub and Anspach) is very intimidating when walking along Druid Street.

Thank you kindly for your attention to this matter

Sincerely

[REDACTED]

[REDACTED]
Druid Street London
SE1 2DX

16th June 2018

Re: licensing opposing 130 Druid St.

This is based on:

128 BOTTLE Shop

118 Anspach & Hobday

The Marquis of Wellington public house
Saturdays from 1pm until 11pm is like a
football match crowd, no peace at front of
home nor a back, cannot open windows even
in extreme heat due to noise levels. This is
not every weekend but majority of Saturdays.
People using estate as toilet.

Noise of glass bottles being emptied by The bottle
shop and Marquis of Wellington, glass bottles
glasses from Anspach & Hobday glasses for children
to play with in druid st, rubbish cigarette ends.

Druid St
London SE1 2DX

12th June 2018

RE: License 130 Druid Street

We wish to make our feelings unhappiness clear regarding application for a new license. There are already 3 very noisy dance floors from our homes that make life for tenants living on Druid St living hell. All present licensee use road Druid St and allow their drinkers for use estate to use as they wish, toilet, sex, throw rubbish sit here we live after very drunk abuse we don't use druid st to walk through due amount of drunk with present outlets put yet another Alcohol selling archer terrible. At present I no longer feel safe, I feel afraid to walk into druid St the vast amount of people there

(2)

Behaviour. The present business ignore residents asking for quite.

The children that live on estate watch drunken adult behaviour?

children need as do adults to be protected from yet more shouting chanting singing all in Druid st in clear view of children. My wife and I have a wonderful garden that cannot be used due to amount of anti social behaviour. Druid st has been turned into a party road, but no one is stopping any more of these unsupervised drinking cut lets 12-11.130 Druid st wishes to open? no peace now, not able to rest enjoy home, retirement. Southwark not listening to residents complaining. Got to licensing put clauses into licenses yet no one enforcing anti social behaviour. Now with even more drunks in area?

Supporting reps

5

From: [REDACTED]
Sent: Wednesday, June 27, 2018 2:53 PM
To: Regen, Licensing
Subject: Premises License for Rinneroon Ltd 863537

To whom it may concern,

As both a resident of SE1 and a member of the London City Runners Club I would like express my support for the licence application of Rinneroon 863537.

London City Runners provides a free and safe environment for people with a common interest to meet and exercise together. Part of the appeal of the club is the social aspect, it is very keen to promote social cohesion.

Kind regards,

[REDACTED]

[REDACTED] Tower Bridge Road
London

[REDACTED]

6

From: [REDACTED]
Sent: Wednesday, June 27, 2018 6:53 PM
To: Regen, Licensing
Subject: Premises License for Rinneroon Ltd 863537

27 June 2018
London, UK

To whom it may concern,

I'm getting in touch regarding the licence for for Rinneroon Ltd 863537 to show my support for the project.

The London City Runners club hosted in the venue has been hugely beneficial for the SE1 community; the club is open to anyone — and it's free. It makes the community healthier and happier. It's a brilliant place to spend time and get fitter.

As a new resident to the SE1, I can admit that having the LCR on my doorstep was one of the main reasons why I chose to move here.

Best regards,

[REDACTED]

[REDACTED],
Lancaster Street,
SE1 0RW

--

[REDACTED]
[REDACTED]

7

From: [REDACTED]
Sent: Wednesday, June 27, 2018 8:36 PM
To: Regen, Licensing
Subject: Premises License for Rinneroon Ltd 863537

Hello,

My name is [REDACTED], and I am a resident of Southwark living at [REDACTED] near Borough Market. I am writing in support of the Premises License application for the London City Runners. As a resident of the area and a supporter of the club, I would like to submit from personal experience that the club, should the license be approved, will without question prove to be a positive addition to the area due to their being a community-focused organisation designed to promote an active involvement in fitness and healthy activity.

From my perspective, the club has been nothing but positive. I moved here last year from the United States and, as an active runner, found myself looking for an organisation to help me get to know my community from the ground level. As it happens, I stepped out of my flat and saw a group of people running by wearing shirts from the City Runners. I looked them up on social media and met Tim Jones, the head of the organisation, who invited me to attend their weekly running sessions. Despite not knowing anyone, I was warmly welcomed and since then have met many interesting active people and have truly enjoyed my experience. I found Tim to be a person who genuinely cares about his club, its members and the community as a whole. I have every confidence that the warmth and spirit that Tim brings to the club will prove to be evident to the community as well.

I heartily encourage the approval of this license and can answer any questions you may have or offer additional testimony as needed.

Thank you for your consideration in this matter.

Regards,

[REDACTED]

8

From: [REDACTED]
Sent: Wednesday, June 27, 2018 10:15 PM
To: Regen, Licensing
Subject: Premises License for Rinneroon Ltd 863537

Hello,

I'm emailing to show my support of the license application **Rinneroon Ltd 863537**

My name: [REDACTED]

Address: [REDACTED], SE1 [REDACTED]

Date: 27th June 2018

I would like to support the application because as a member of the club, I've experienced the really positive aspects it brings. Firstly, it is a great way for people to get fit and healthy - the club is so welcoming of all types of people, regardless of age, gender, race or fitness level.

It also offers a brilliant social aspect - everyone is so friendly and welcoming. It's a great way to meet people living around my area. I can't quite beleive it's free! Which also means it is accessible to everyone!

King regards,

[REDACTED]

9

From: [REDACTED]**Sent:** 01 July 2018 20:07**To:** Regen, Licensing**Subject:** Premises License for Rinneroon Ltd 863537

Good evening,

I am just emailing in order to voice my support for the proposed liquor license for Tim and the team at London city runners.

Having recently moved into the SE1 area from New Zealand, I was really keen to find a running club in order to meet new friends and find running routes with less foot traffic. The London City runners club has been fantastic in this respect and I have enjoyed getting to know all of the wonderful people there. I really do think encouraging people to be active and social is paramount in this day and age in order to avoid loneliness and a temptation to avoid exercise. The London City runners are great for this and bring a real sense of community to the area for like minded people. Running at night can be extremely dangerous particularly for women and a running club allows people to run in safety.

Feel free to get in touch with me on the following contact information should you want to hear further:

[REDACTED]

[REDACTED]

1 July 2018

Thanks,

[REDACTED]

10

From: [REDACTED]
Sent: 02 July 2018 12:03
To: Regen, Licensing
Subject: Please approve licence for for Rinneroon Ltd 863537, support

Dear Southwark Licensing,

I'm contacting you regarding the licence for for Rinneroon Ltd 863537 to show my support for the project.

I've owned my place very near this venue at [REDACTED], having the LCR on my doorstep was one of the main reasons I like living here.

The London City Runners club hosted in the venue has been hugely beneficial for the SE1 community; the club is open to anyone — and it's free. It makes the community healthier and happier. It's a brilliant place to spend time and get fitter.

Best regards,

[REDACTED]

11

From: [REDACTED]**Sent:** 02 July 2018 12:16**To:** Regen, Licensing**Subject:** Premises License for Rinneroon Ltd 863537

I am writing in support of the licence application for Rinneroon Ltd 863537.

London City Runners is an invaluable part of the local community in SE1, offering a free, friendly club for anyone in the neighbourhood, and beyond, who wants to get fit; and I feel it is important to support their application for dedicated premises, as it will enable the club to become even more of a community asset.

Although I don't run with the club myself, I encouraged my wife to join as it provides a safe, group environment for everyone, but particularly women and the more vulnerable members of society who otherwise might have to go running by themselves; especially important during the winter months when they would have to be out running in the dark.

Our six-year old daughter also loves hanging out with the runners on their club nights!

yours sincerely,

[REDACTED]

[REDACTED]

[REDACTED]

[REDACTED]

[REDACTED]

[REDACTED]

12

From: [REDACTED]
Sent: 29 June 2018 19:08
To: Regen, Licensing
Subject: Premises License for Rinneroon Ltd 863537

Dear sir/madam,

My name is [REDACTED], and I live at [REDACTED], SE1 [REDACTED].
I am supporting the application Rinneroon Ltd 863537.

I have been running with this group over 6 years, since my daughter is 1 month old.
When I started I was a new mum as well as new to the community, also could hardly run more than 3 KM continuously.

This running group has been very friendly, and nice mixture of local people and professionals who working in the city (I am both), and motivating people to run constantly and challenge to the next level in positive way. I did two half marathon this year so far (Big half and Hackney half), which I could not expect myself 6 years ago,

The club run completely free, asking the favour of the local pubs as the meeting points over years. it was so generous for both running club and local pubs, but now they need their own place as so many runners cannot fit any of the pubs!

It will be a nice meeting point, community centre for runners of both local and city working professionals. I strongly support this planning.

Kind regards,

[REDACTED]
29/06/2018

--

13

From: [REDACTED]
Sent: Monday, July 02, 2018 9:39 PM
To: Regen, Licensing
Subject: Premises License for Rinneroon Ltd 863537

Hi,

Please find below my support for application: Premises License for Rinneroon Ltd 863537

My address:

[REDACTED]
[REDACTED]

SE1 [REDACTED]
02/07/2018

Date of support email:
02/07/2018

Application supporting:
Rinneroon Ltd 863537

Why I am supporting this application:

I have been attending this club for several months now. It is a free running club that encourages anyone who is interested in running, meeting new people, staying healthy and socialising to participate.

As an SE1 resident I believe this club increases the social bond in the community by bringing together people from all walks of life. The club, being a running club, encourages the health and well being of it's members as well as networking amongst members before and after running events.

This club provides a healthy and social alternative activity for many people of all different ages. I really enjoy having a beer with members of the group after the runs and an alcohol premises license would add to this experience and encourage further bonding amongst members of the community via the club.

Kind regards,

[REDACTED]

14

From: [REDACTED]
Sent: 04 July 2018 17:24
To: Regen, Licensing
Subject: In support of Premises License for Rinneroon Ltd 863537

Dear all,

I am writing in support of Premises License for Rinneroon Ltd 863537 on Druid Street.
I am a local resident, living two minutes from the venue.

I believe this venue will help reduce noise and public nuisance in the area. I know this sounds somewhat counterintuitive, but here is my reasoning: The venue will host London City Runners, a running club which meets three times a week in the area's existing venues. The club is incredibly popular and regularly attracts over 100 runners. Until now, the club has relied on local bars to meet -- and because of its popularity, this often means "spillovers" from the bars into outdoor areas. Opening its own venue will prevent this from happening, keeping the runners inside.

Unlike other bars, this club does not attract people who smoke (runners rarely do), which means there will be no need for people to stand outside in front of the venue.
Noise will be reduced thanks to this venue.

On top of this, I would like to point out that the Running Club has brought a lot of good things to the local community. It has motivated people who have never exercised, and brought together local residents from various walks of life.
It has also organised fundraisers for local charities.

I hope you will consider my contribution when deciding on this license.
Best wishes,

[REDACTED]
[REDACTED]
[REDACTED] Wolseley St.
London - SE1 [REDACTED]

15

From: [REDACTED]
Sent: Friday, June 29, 2018 1:45 PM
To: Regen, Licensing
Subject: Alcohol license - LCR

Hi there,

This is just a quick email to show my support for Rinneroon Ltd 863537 aka London City Runners.

I'm a proud resident of SE1 and absolutely love the area, this is largely due to having this incredible club just a short walk away. Through this club I've made a ton of friends in the area and we regularly frequent the pubs and cafes here.

This running club has provided a central place for us to hang out, socialise and get fit. If you came along for a drink after a run sometime you'd see the friendliest people high on endorphins socialising and feeling great.

Hoping this helps to shed some light on how much this club serves the community in SE1 and further afield.

Lots of love,

[REDACTED]

16

From: [REDACTED]
Sent: 29 June 2018 22:19
To: Regen, Licensing
Subject: Premises License for Rinneroon Ltd 863537

29/06/18

Dear Southwark council,

I joined London city runners to help train for a half marathon, thinking I'd stop straight afterwards. The race came and went yet I'm still with the club. I knew nobody yet was welcomed with open arms and haven't looked back.

It's such a friendly environment full of lovely people who enjoy running. I really look forward to running club during the week. Its free, a very safe environment and I've never been fitter.

I think London City Runners is a great part of the community and feel lucky to be close enough to enjoy it.

Kind regards,

[REDACTED]

[REDACTED]

Supporting Rinneroon Ltd 863537

From: Tim Jones [mailto: [REDACTED]]
Sent: Friday, July 13, 2018 5:41 PM
To: Mills, Dorcas
Subject: Premises Licence Application - Rinneroon, 130 Druid Street, London SE1

Dear Dorcas,

Many thanks for your email. I've now contacted all of the officers concerned and cc'd you into my responses. We hope this addresses all the points raised. Below in red is our response to any residents who may feel opposed to our license.

I do hope this resolves matters for the respective authorities and residents. We very much want to work with all parties concerned to promote health and well being in our local community and will more than happy to address any further topics.

Kind regards

Tim

We believe the venue will help reduce noise and public nuisance in the area. It will serve as the base for London City Runners, a running club which meets four times a week in the area's existing bars -- the Bottle Shop, and the Marquis of Wellington.

The club is incredibly popular and regularly attracts large number of runners who will now be able to be contained safely within the premises. This will decrease noise pollution and allow us to further help the local community get into sport.

Unlike other bars, this venues is unlikely to attract smokers (runners rarely smoke), which means there will be no need for people to stand outside in front of the venue. The x 3 toilets we provide and the mens urinal we feel will actively ensure that our members would never have a need to urinate outside of the premises. We'll have x4 high definition CCTV cameras and if any member were to be found to doing this they would no longer be allowed to be part of the club.

From: Earis, Richard
Sent: Wednesday, July 18, 2018 2:26 PM
To: Regen, Licensing
Cc: Mills, Dorcas; 'Tim Jones'
Subject: RE: Premises Licence Application - Rinneroon, 130 Druid Street, London S~E1

Dear Licensing,

On the basis of the agreement\conditions below and the attached plans I confirm I have conciliated my objections to this proposal with the applicant. I have no further objections to grant of the License.

Kind Regards,

Richard

Richard Earis
Principal Environmental Protection Officer
Environmental Protection Team

020 7525 2469

Postal address: Southwark Council | Environmental Protection Team | Regulatory Services | 3rd Floor Hub 1 | PO Box 64529 | London | SE1P 5LX.

Office address (By appointment only): Southwark Council | Environmental Protection Team | Regulatory Services | 3rd Floor Hub 1 | 160 Tooley Street | London | SE1 2QH

www.southwark.gov.uk

visit: <http://www.southwark.gov.uk/air-quality>



Please consider the environment - do you really need to print this email?

Kind Regards,

Richard

Richard Earis
Principal Environmental Protection Officer
Environmental Protection Team

From: Tim Jones [
Sent: Wednesday, July 18, 2018 2:00 PM
To: Earis, Richard
Cc: Mills, Dorcas
Subject: Re: Premises Licence Application - Rinneroon, 130 Druid Street, London S~E1

Dear Richard,

Please find attached a more detailed plan which illustrates the extent of the licensable area. This will not encompass any part of the loading bay. The planning consent is in process and we agree to all of the conditions you've detailed below. All staff will be trained to enforce these conditions.

Kind regards

Tim

From: Chowdhury, Farhad
Sent: Tuesday, July 17, 2018 6:37 PM
To: 'Tim Jones'
Cc: Mills, Dorcas; Regen, Licensing
Subject: RE: Premises Licence Application - Rinneroon, 130 Druid Street, London S~E1

Hi Tim,

Thanks for sending the risk assessments and revised plans for the premises, I am now withdrawing my representation with regards to the outside area.

Kind regards,

Farhad Chowdhury

Principal Enforcement Officer | Southwark Council | Regulatory Services | EHTS (Health and Safety Team)

Postal Address:

Health and Safety Team | 3rd Floor, Hub 1 B | PO Box 64529 | London | SE1P 5LX

Visitor's Address:

160 Tooley Street | London | SE1 2QH

☎ Tel: 020 7525 0398

☎ Admin Tel: 020 7525 4261

🌐 Website: www.southwark.gov.uk

E-mail: farhad.chowdhury@southwark.gov.uk

🌱 Please consider the environment - do you really need to print this email?

"Southwark Council does not accept liability for loss or damage resulting from software viruses.

The views expressed in this e-mail may be personal to the sender and should not be taken as necessarily representing those of Southwark Council. The information in this e-mail and any attached files is confidential and may be covered by legal and/or professional privilege or be subject to privacy legislation. It is intended solely for the individual or entity to which it is addressed. If you are not the intended recipient, the retaining, distribution or other use of any transmitted information is strictly prohibited. E-mails are transmitted over a public network and Southwark Council cannot accept any responsibility for the accuracy of a message that may have sustained changes in transmission"

http://www.southwark.gov.uk/info/200049/health_and_safety/3547/1_health_and_safety_team

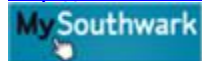

For council services at your fingertips, register online at www.southwark.gov.uk/mysouthwark

From: Tim Jones [<mailto:londoncityrunners@gmail.com>]
Sent: Friday, July 13, 2018 5:30 PM
To: Chowdhury, Farhad
Cc: Mills, Dorcas
Subject: Premises Licence Application - Rinneroon, 130 Druid Street, London S~E1

Dear Farhad,

Please see my responses below in red and don't hesitate to contact me if there is anything else we can do to alleviate your concerns.

Kind regards

Tim
Director

1. Explain how the applicant will deal with public safety, customers who want to sit outside drinking will be sitting on the public highway where cars drive by, there is a risk of vehicles driving into customers drinking outside the proposed area. This is a serious risk of road accidents/collisions with on Druid street due to the number of vehicles using the road day and night. It is not suitable to allow drinking outside on the public highway unless suitable measure are put in place.

We are now installing our front door over 2 metres into the footprint of our premises thereby increasing external space but still within the unit so as to prevent over crowding into the public highway. This will allow a greater number than 5 persons outside but will not infiltrate the area of the public highway thereby causing no nuisance nor danger. This is to the detriment of our internal plans but alleviating your concerns are our priority and this is a viable solution to allow a controlled environment. This means that there will be a space of approximately 7 to 8 square metres within the footprint of our premises which will take our customers off the pavement area. This should alleviate the concerns that you had. Please see a sketch illustrating this attached.

2. A comprehensive site specific risk assessments to be done by a competent person and submitted to this Department.

Attached

Farhad Chowdhury

Principal Enforcement Officer.

Farhad.chowdhury@southwark.gov.uk

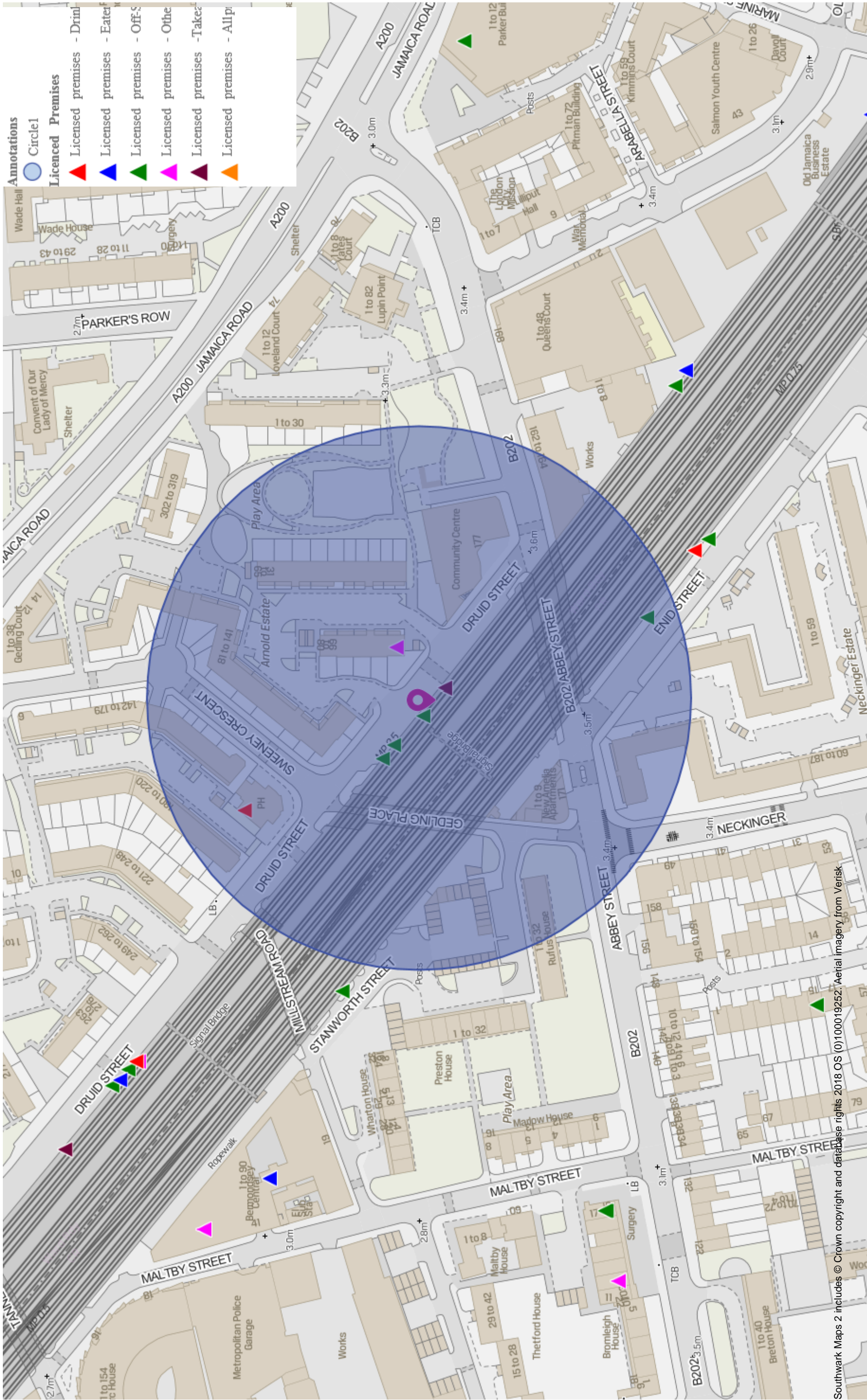

Southwark Maps 2 includes © Crown copyright and database rights 2018 OS (0)100019252. Aerial imagery from Verisk

LICENSING SUB-COMMITTEE DISTRIBUTION LIST (OPEN) MUNICIPAL YEAR 2017-18

NOTE: Original held by Constitutional Team; all amendments/queries to
Andrew Weir - Tel: 020 7525 7222

Name	No of copies	Name	No of copies
Members		Officers	
Councillor Adele Morris	1	Debra Allday, legal team	1
Councillor Sunny Lambe	1	Dorcas Mills, licensing team	1
Councillor Charlie Smith	1	Jayne Tear, licensing team	1
Councillor Eliza Mann	By email	Graham White, Metropolitan Police Service	By email
		Andrew Weir (spares)	6
		Total printed copies:	12
		Dated: 24 July 2018	